

Single Mode Manual Variable Optical Attenuator (MVOA)

Single Mode Manual Variable Optical Attenuator (MVOA)

Features	
High precision	
Wide attenuation range	
Low Insertion Loss	
Compact size	
Application	
Optical communication systems test	
Optics lab use	

Specifications:

Parameter \ Type	1310nm	1550nm	1310/1550nm	1064
Wavelength (nm)	1310 ± 40	1550 ± 40	1310 ± 40 & 1550 ± 40	1064 ± 20
Attenuation range (dB)	0.6 ~ 60	0.6 ~ 60	0.8 ~ 60	0.6 ~ 60
Insertion Loss (dB)	≤0.6	≤0.6	≤0.8	≤0.6
Return loss (dB)	≥50			≥50
Fiber Type	SMF-28e			HI1060
Adjustment Precision (dB)	0.02			
PDL (dB)	≤0.15			
Operating temperature (°C)	0 ~ +70			
Storage temperature (°C)	-40 ~ +85			
Dimension (mm)	26 x 16 x 8			

Package Dimensions

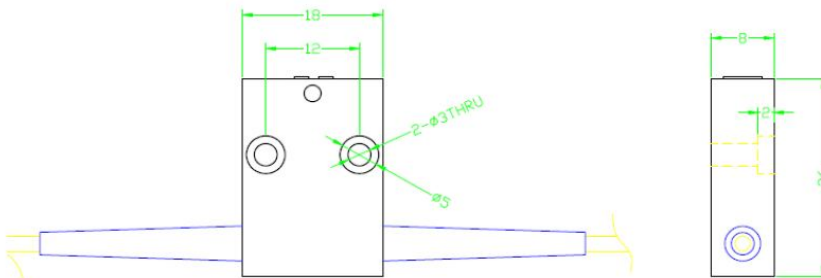

Ordering Information

MVOA	Wavelength	Adjustment Type	Pigtail Type	Fiber Type	Length	Connector
	1064	1= Hand adjustment	900=900um tube	1=SMF-28e	1= 1m	NE=None FA=FC/APC FC=FC/UPC SA=SC/APC SC=SC/UPC LC=LC/UPC LA=LC/APC MU=MU/UPC XX=Other
	1310	2= Screw adjustment	2000=2mm tube	4=HI1060		
	1550		3000=3mm tube			
	1310/1550					